

This drawing is valid for commercial purposes only and must not be copied, disclosed or used without our permission

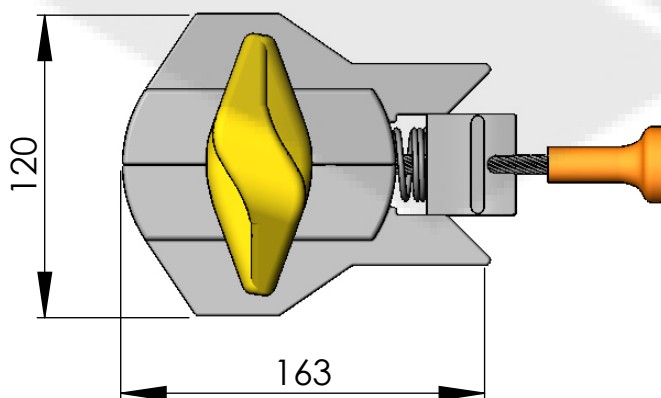
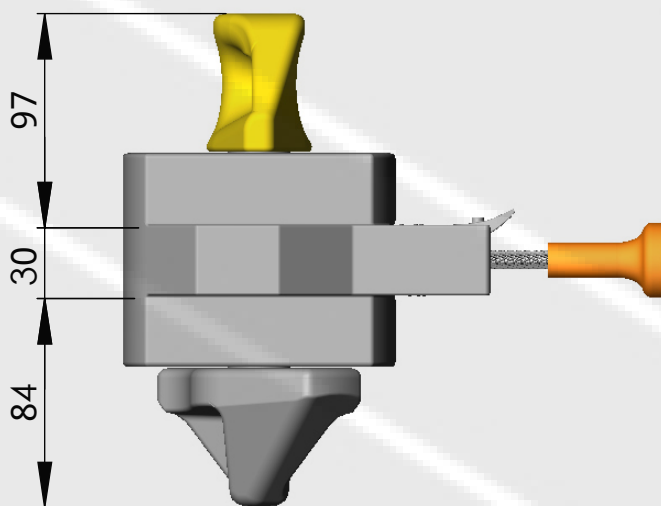
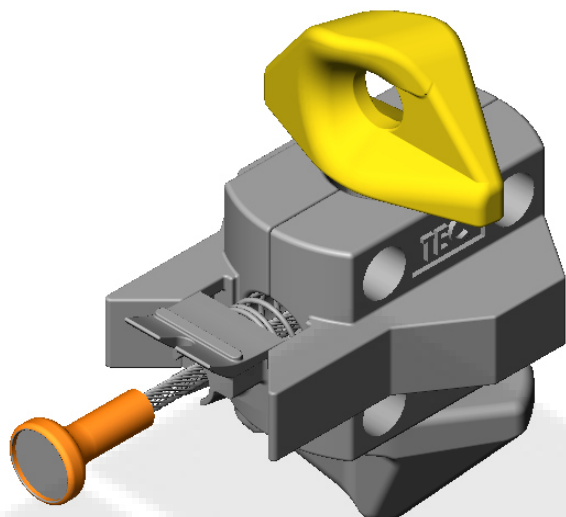

Material: Ductile Iron (housing)
Drop forged (cone)

Weight: 5.2 kg

SWL Tension	250 kN	SWL Shear	210 kN
BL Tension	500 kN	BL Shear	420 kN

SALADA INDUSTRIES FOR METAL
+966 50 016 5914
www.salada.sa
hello@salada.sa



Description:

**SEMI-AUTOMATIC
TWISTLOCK**

Reference:

CI-45-1

Real pieces might have variations in details such as weight and sizes